

Cast-In Firestop Devices (CP 680-P and CP 680-M)

For use in

- Dust and fiber free environments such as hospitals, computer centers and laboratories
- Concrete floor assemblies rated up to 4 hours

Product description

- A one-step cast-in firestop device for a variety of pipe materials and diameters
- Helps reduce labor costs and increase productivity
- Ready-to-use out of the package
- Internationally tested and approved by UL and FM
- Reduces the chance of project delays due to failed inspections

Product features

- Quick and simple installation
- SpeedLine Alignment system promotes faster layout
- QuickTurn System creates fast, simple vertical connections
- Integrated moisture and smoke seal
- Innovative adapter for metal deck applications

Installation and applications

- Concrete floors from 2.5" (63 mm) thickness for either flat concrete or concrete over metal deck

CP 680-M:

- Insulated and non-insulated metal pipes
- EMT and electrical conduits
- Cable bundles
- Multiple pipes

CP 680-P:

Addresses all applications for CP 680-M as well as the following:

- Plastic pipes such as PVC, CPVC, ABS, ENT and FRPP
- Fresh and waste water pipes

Not suited for

- Areas with high condensation
- Outdoor areas
- Wall applications

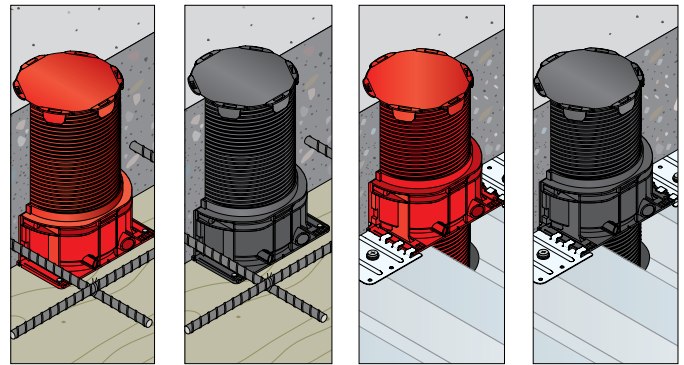

CP 680-P in concrete over wood forms

CP 680-M in concrete over wood forms

CP 680-P over metal deck

CP 680-M over metal deck

Technical Data		CP 680-P and CP 680-M
ID	Footprint	Opening required thru metal deck
2"	3-3/4" x 4-1/2"	3-1/2" diameter
3"	4-3/4" x 5-5/8"	4-1/2" diameter
4"	6-3/8" x 6-3/4"	5-1/2" diameter
6"	9" x 9-1/2"	7-1/4" diameter
Expansion temperature		392°F (200°C)
Expansion rate		1:50 (unrestrained) 1:30 (Load expansion, Load = 20g/cm ³)
Standard height		8"
Temperature resistance		Maximum 212°F (100°C)
Color		CP 680-P: red CP 680-M: black

Tested in accordance with

- UL 1479 • ASTM E 814 • ASTM G21

Internationally tested and approved

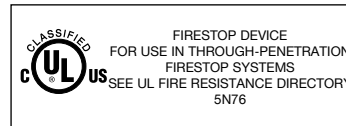

Installation instructions

Notice

- Before handling, read Material Safety Data Sheet and product label for safe usage and health information.
- Instructions below are general guidelines — always refer to the applicable drawing in the UL Fire Resistance Directory or Hilti Firestop Systems Guide for complete installation information

Instructions for use

- Before pouring concrete, secure the cover cap in place, thereby preventing the flow of concrete into the cast-in device
- Do not use for wall applications

Concrete floor with metal decking

For concrete floor with metal decking applications use the correct size CP 680 Metal Deck Adapter for installed cast-in device and follow the illustrations.

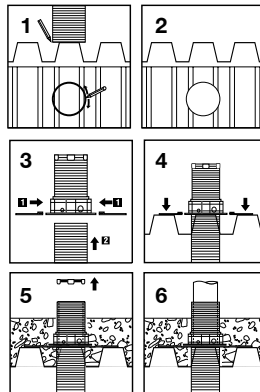

Concrete floor

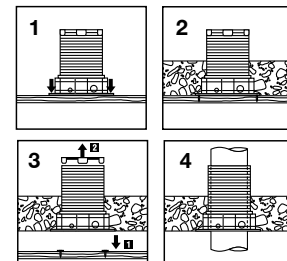

Installation option

Follow the illustrations if CP 680 has to be cut to slab thickness before installation, or when riser clamps are used.

